



28 King Street Wakefield WF1 2ST

PROPERTY FEATURES

- Large storage space / lock-up
- Approx 2150 sq ft (200 sq m) to ground floor
- Accessible first floor space also included
- Versatile temporary space available to let
- Suitable for a variety of business uses
- Wakefield City Centre location
- Former court offices
- Flexible lease terms of upto 2 years
- For all enquiries contact FSL Estate Agents



01924 200101



Annual Rental Of £9,995

Ground Floor

Approx. 200.1 sq. metres (2153.9 sq. feet)

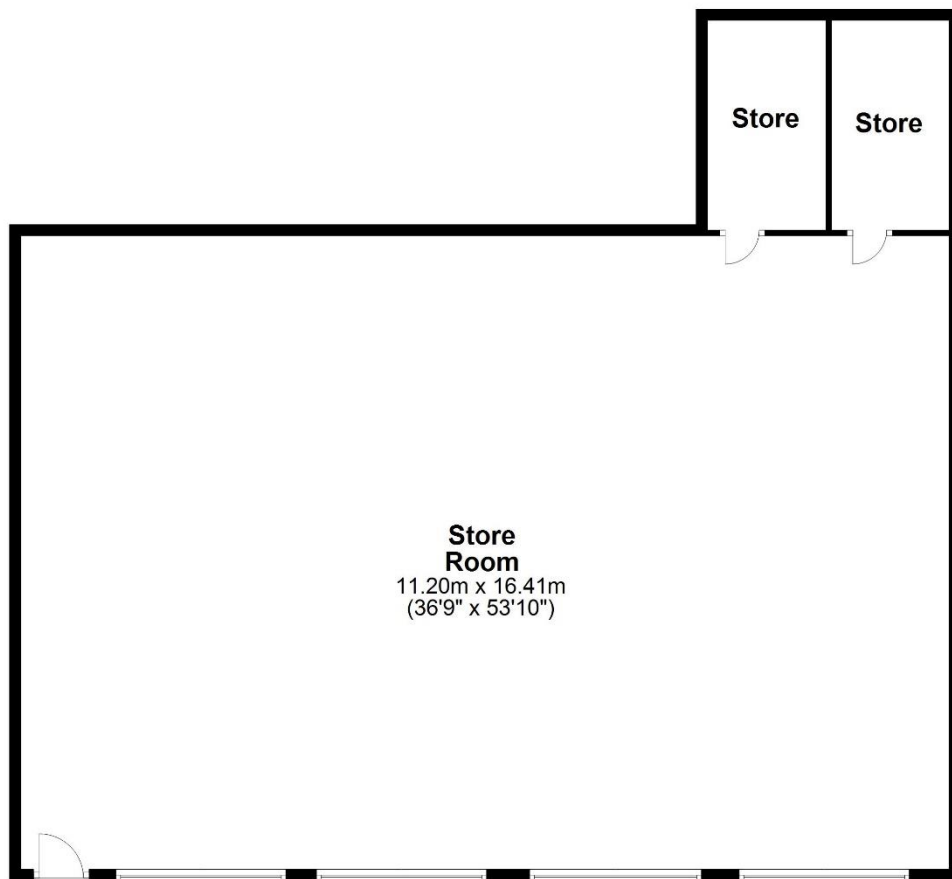
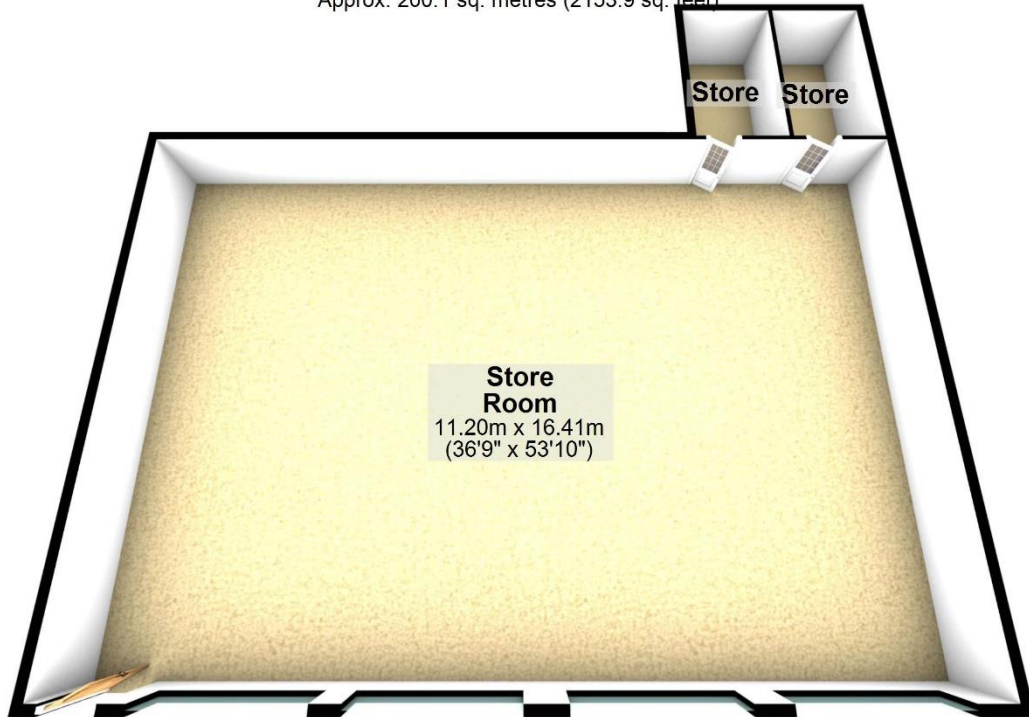

28 King Street, Wakefield

PROPERTY DETAILS

Former Wakefield city centre court offices now available to let for storage space / commercial lock-up.

SIZE

Ground floor area of approximately 2150 sq ft (200 m2). Note that any accessible first floor space is also to be included within the lease.

LEASE TERMS

Flexible lease terms by negotiation for a period of upto 2 years.

UTILITIES

We are advised that there are no mains services currently connected at the premises.

RATEABLE VALUE

The rateable value is currently being reassessed.

VAT

The agreed rent will be subject to VAT which will be added at the standard rate.

VIEWINGS

For all enquiries please contact our friendly team on 01924 200101.

IMPORTANT NOTICE

These particulars are intended only as general guidance. The Company therefore gives notice that none of the material issued or visual depictions of any kind made on behalf of the Company can be relied upon as accurately describing any of the Specified Matters prescribed by any Order made under the Property Misdescriptions Act 1991. Nor do they constitute a contract, part of a contract or a warranty.



For further information and to arrange a viewing contact FSL Estate Agents

Telephone **01924 200101**

PRSA Property Redress Scheme

FSL Estate Agents Ltd, 8 Lakeside, Calder Island Way, Wakefield, WF2 7AW

Tel / Fax: 01924 200101 Web: www.fslestateagents.com E-mail: enquiries@fslea.com

FSL Estate Agents wish to advise prospective purchasers that we have not checked the services or appliances. The sales particulars have been prepared as a guide only. Any floor plan or map is for illustrative purposes only. FSL Estate Agents, for themselves and for the vendors or lessors of this property whose agent they are give notice that the particulars have been produced in good faith; do not constitute any part of a contract; no person in the employment of FSL Estate Agents has any authority to make or give representation of warranty in relation to this property.